

IN ACCORDANCE WITH TITLE 24  
 OF THE CALIFORNIA BUILDING  
 CODE, THE BUILDER SHALL ALSO  
 PROVIDE AND MAINTAIN WATER  
 TIGHTNESS THROUGHOUT THE  
 ENTIRE PROJECT.  
 COMPLIANCE TO BE PROVIDED

C. FILL INSULATION IS USED  
 TERMS SHALL BE CERTIFIED  
 INCLUDING SILEX PLATES.  
 C. STANDARDS.  
 BE 4" MAX. ABOVE FINISHED FL.  
 INCHES OF COMPRESSION  
 HORIZONTAL TO AIR

SYSTEM PER TITLE 24,  
 C. ALL TOILETS SHALL BE  
 6 GALLONS, ALL SHOWER HEADS  
 - HOT WATER FAUCETS THAT  
 WATER HEATER SERVING SUCH  
 ROOMS, A SOLID GLUE PLASTIC  
 MINIMUM OF +1/2" FROM F.F.

TANK, EQUIPPED WITH A READY  
 HANDLE IS TO BE MORE THAN

TO

38 APPROVED METHOD,  
 FASTENED TO THE ROOF  
 SHALL BE SECURELY  
 MANUFACTURER AND SUPPLIER  
 : SETBACK  
 CTS, INSTALLED AND  
 UNOBTAINED SPACES,  
 NON-ABSORPTIVE MATERIAL,  
 SIDES AND ABOVE.

FIVE-TONE  
 DOWNWARD  
 2" SPANLESS - STEEL,  
 150' OF TENSILE  
 S.

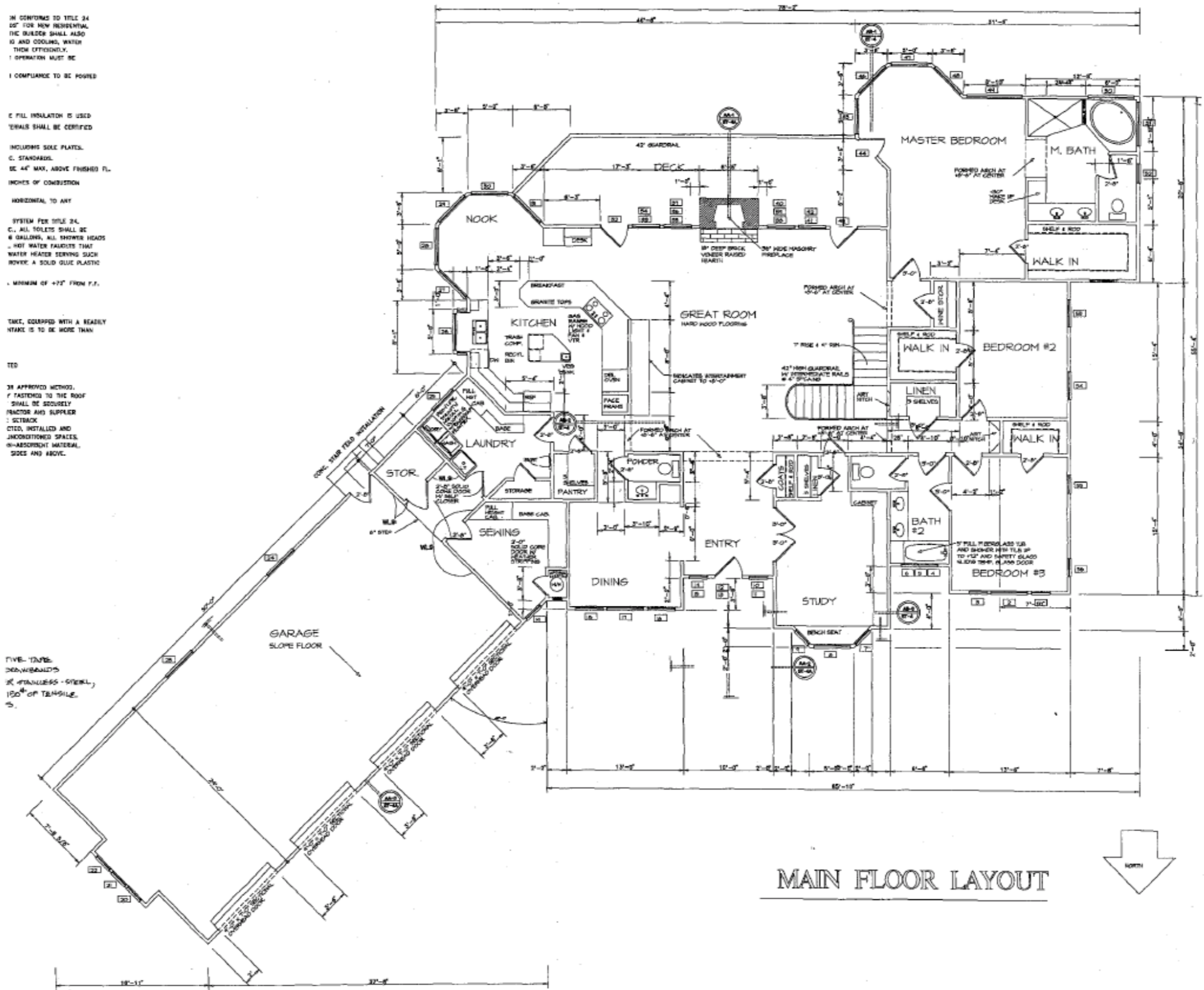

MAIN FLOOR LAYOUT



